

## AT-NC-LED800

### Nurse Call LED Corridor Display



**AT-NC-LED800**, LED Corridor Display are installed in corridors for easy observation by nurse/doctor in the corridor.

#### System Connection Diagram

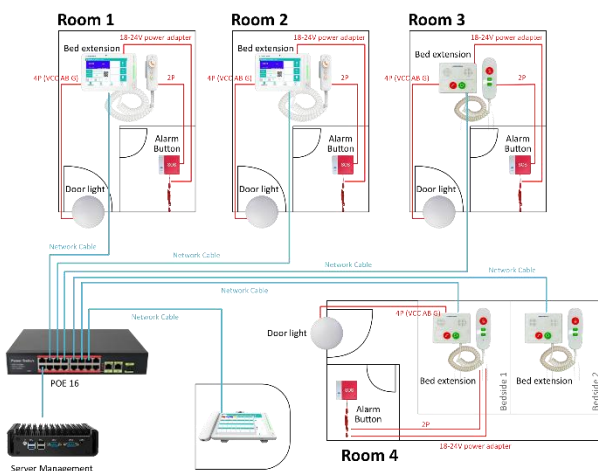

- **Installation method:** Lifting
- **LED display colors:** Red, Green, Yellow

#### Technical Specification

LED brightness	≥900cd/m <sup>2</sup>
Pixel spacing	4.75mm
Resolution	128 wide, 32 high
Communication method	Support RS485 and TCP/IP communication
Power	≤80W
Working Voltage	ACC220V/50HZ input, DC5V output
Dimension	852mm x 186mm x 50mm